

Perma-Link™ 50 Amp Devices

Portable Power



ERICSON
SAFETY IS OUR STANDARD

PERMA-LINK®



Click the image above for purchasing information.

Standard Features:

- UL Listed, CSA Certified, cETLus Listed
- Rugged nylon construction resists high impact and jobsite oils & chemicals
- Nickel plated blades and stainless steel screws provide optimum corrosion resistance
- Optional Sealing boots with sealing ring offer additional moisture, dust protection and UV protection

50 Amp California Style



E-Style CS6364-C



E-Style CS6365-P



Unique Features:



Impact, jobsite
chemical and oil
resistant.



Plated blades and
screws.



External cord clamp &
internal seal.
*E-Style CS6364-C & CS6365-P
models only.*

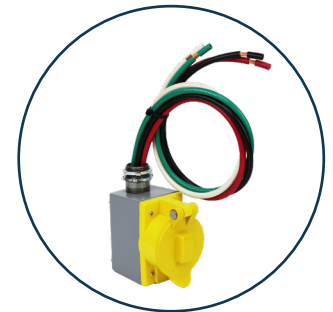

SR50 Receptacle
Assembly with 21"
Leads.

Selection Guide:

Face View	NEMA	Electrical Ratings		Perma-Link		Receptacles	Flanged Inlets	Inlet with Flip Cover
	Config	Amps	Volts	Plugs	Connectors			
Locking, 2-pole, 3-Wire Grounding								
	Non-Nema	50	250VDC,600VAC	3763-P	3762-C	3771	3777	-
Locking, 3-pole, 3-Wire Grounding								
	Non-Nema	50	250VDC,600VAC 250VDC,600VAC	3765-P 7765-P(1)	3764-C 7764-C(1)	3769 7379	3775 7958	-
Locking, California Style, 2-pole, 3-wire Grounding								
	Non-Nema	50	125	CS6361-P	CS6360-C	-	-	-
			250 480	CS8265-P CS8465-P	CS8264-C -	CS8269 CS8469	CS8275 -	
Locking, California Style, 3-pole, 4-wire Grounding								
	Non-Nema	50	125/250 480,3 ϕ 250,3 ϕ	CS6365-P CS8165-P CS8365-P	CS6364-C CS8164-C CS8364-C	CS6369 CS8169 CS8369	CS6375 CS8175 CS8375	CS6375-F

Notes:

1. For replacement use only, not recommended for new installations
2. Contact factory for custom assemblies

Sealing Collar System

Our exclusive sealing collar system is available to provide maximum moisture protection between cordsets. The two boots are securely sealed together with threaded polycarbonate rings.

Perma-Link® 50-Amp Accessories	Catalog Number
Weatherproof boot for plugs or connectors	7717
Sealing Collar for weatherproof boots	510RR
Weatherproof receptacle cover	7788CR

Note: 7717 & 510 RR not compatible with E-Style CS6365P & CS6364C.



7788CR



7717



510RR



7717

Product Specifications:

Plug

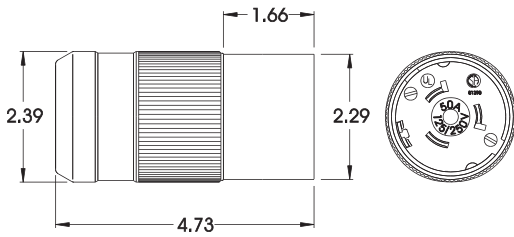

Connector

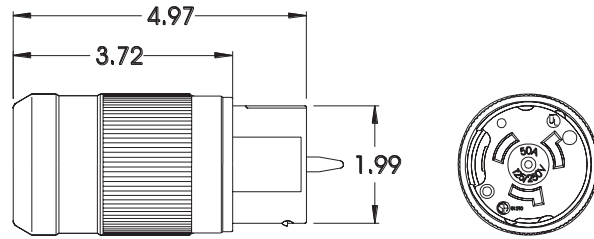

Receptacle

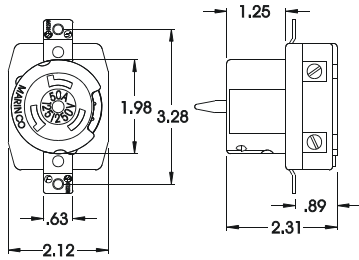

Inlet with Flip Cover

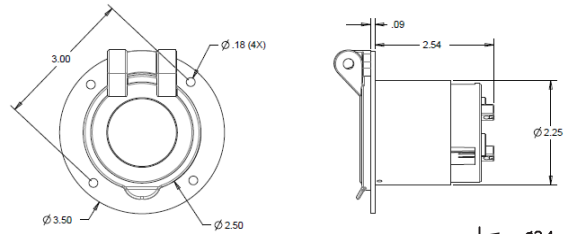

E-Style CS6365-P

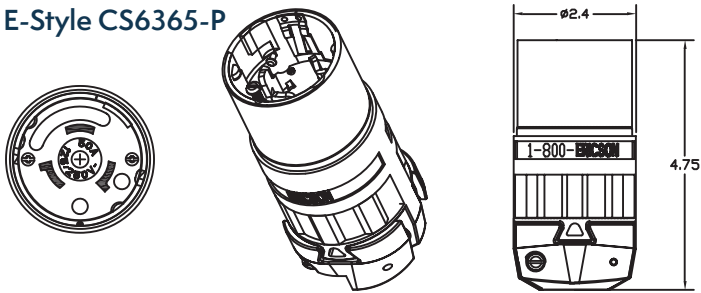

E-Style CS6364-C

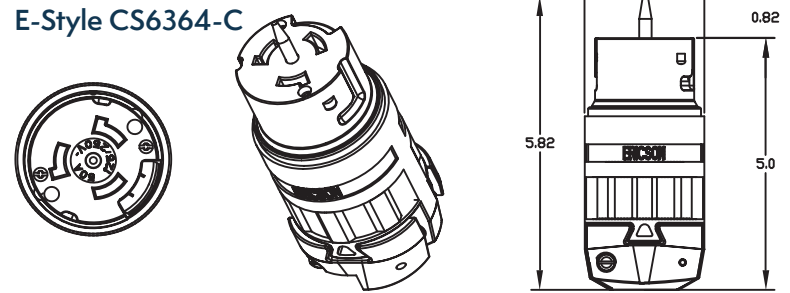

Related Products:

Click on an image or scan the Q for more product information.



Cordsets
63ASO, 63BSO &
63DSO



Perma-Link
1510-P, 1610-C



Perma-Grip
1510-PG, 1610-CG



Hospital Grade
1530 PH, 1630 CH



SmartMonitor
AEGCP Compliant
1510-PML/GML, 1610-CML/GML



SmartMonitor
AEGCP Compliant
1510-PW6PL, 1610-CW6PL



Perma-Tite
IP69k Water Tight
1510-PW6P, 1610-CW6P



Perma-Kleen Antimicrobial
IP69k Water Tight
1510 PW6P-AM, 1610 CW6P-AM



Ericson Manufacturing Company
4323 Hamann Parkway
Willoughby, OH 44094, USA



1-800-Ericson
info@ericson.com
L1000881B